

**West Campus:
Claflin, Sleeper, and Rich Halls
273, 275, and 277 Babcock Street**

This expansive residential facility, located at the west end of campus, is comprised of three thirteen-story buildings: Claflin, Sleeper and Rich Halls. Claflin Hall and Sleeper Hall are connected on the ground floor by a recently renovated, air-conditioned dining hall.

The residential floors are arranged with corridors of double and single-occupancy rooms with two shared bathroom areas. Guestrooms include a bed, desk, dresser, and closet for each occupant. Please refer to the floor plan below for a typical double-occupancy room. All three buildings are non air-conditioned except for the dining room. There are laundry facilities, vending machines in each building.

The residential safety staff operates a security desk 24-hours a day, seven days a week for the safety and convenience of residential guests. An ID card is issued to each resident in order to gain access to the buildings.

The Events & Conferences Front Desk Staff is available to assist guests with checking in to the residence halls on their designated arrival date beginning at 3:00pm. Guests must check out prior to 11:00am on their designated departure date. The Front Desk Staff is also available on a daily basis to assist guests with both campus and area information.

The West Campus complex is situated in close proximity to athletic, meeting and conference facilities. Daily and overnight parking is available in a nearby lot. Arrangements for both dining and parking should be made prior to arrival. West Campus is located one block from public transportation.

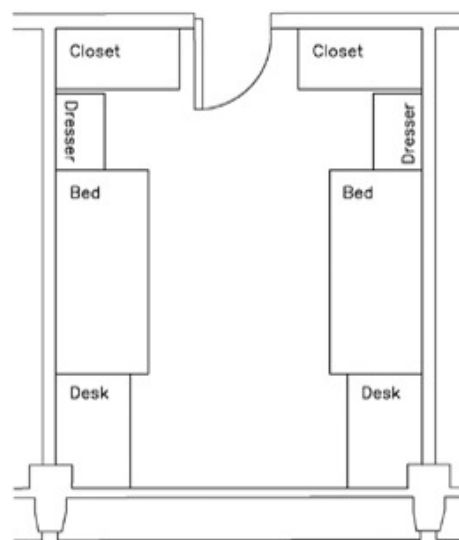

BU Events & Conferences

